

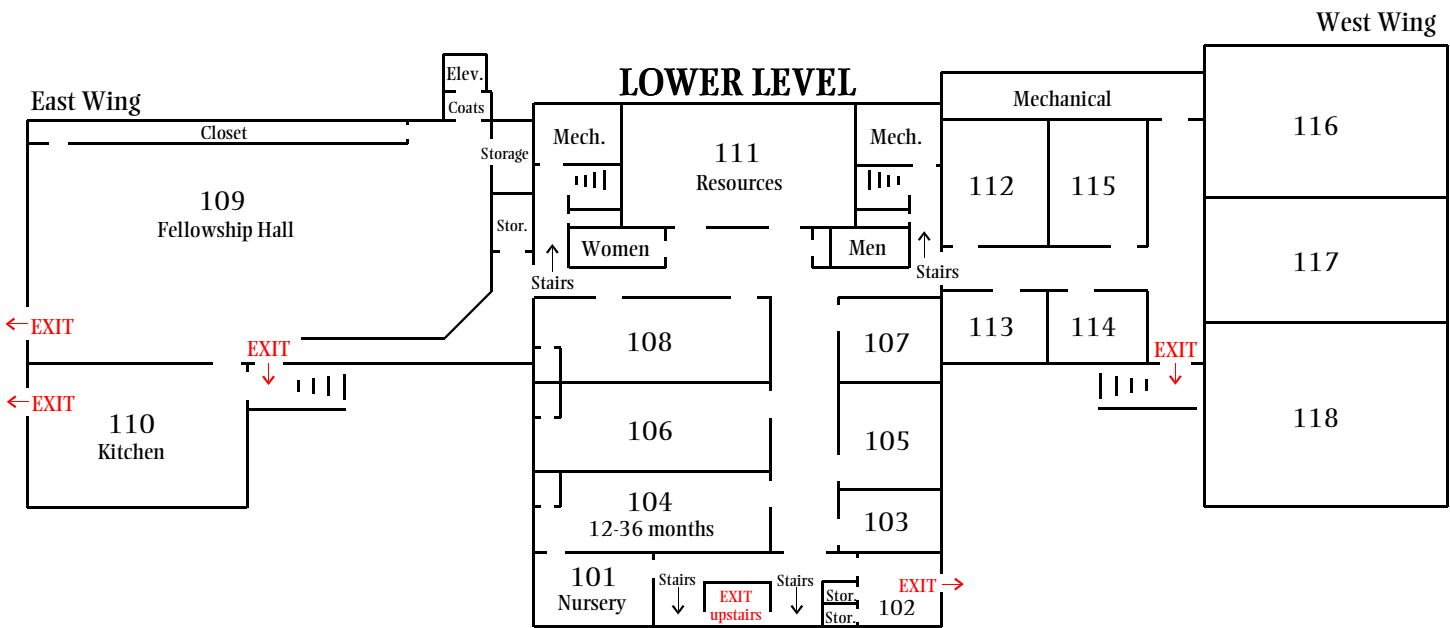

Facilities Map & Directory

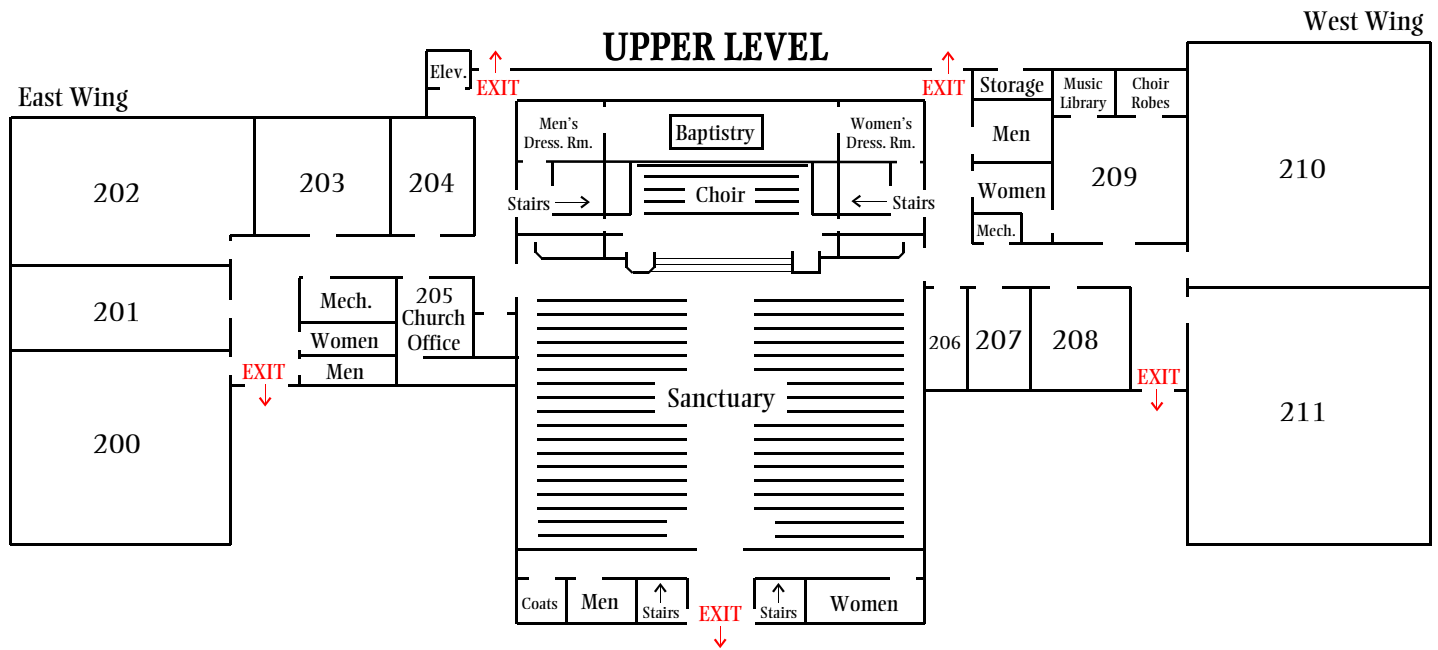

UPPER LEVEL

- | | |
|--------------------------------------|--------------------------------|
| 200 Chapel/Kids For Christ | 206 Communion Prep. |
| 201 Senior Minister | 207 Financial Secretary |
| 202 Parlor/Chr. Workers Class | 208 Library |
| 203 Associate Minister | 209 Choir/Rehearsal |
| 204 Copier/Workroom | 210 Bond Between Us |
| 205 Church Office | 211 ABC/Volunteers |

LOWER LEVEL

- | | | |
|-------------------------------|--------------------------------|---------------------------------|
| 101 Nursery | 107 5th/6th grades | 113 7th/8th grades |
| 102 Children's Library | 108 4-5 years old | 114 Koinonia Class |
| 103 Drama Storage | 109 Fellowship Hall | 115 1st/2nd grades |
| 104 12-36 months old | 110 Kitchen | 116 Prospector's Class |
| 105 Education Storage | 111 Education Resources | 117 180° Worship (youth) |
| 106 Kids Choir/Bells | 112 3rd/4th grades | 118 180° Game (youth) |